

SEATRONICS ST-30 THRUSTER

ITEM CODE: 903596

- 6.5kgf of additional thrust compared to the market leading brand
- Depth rating available to 6000m
- Large inventory immediately available

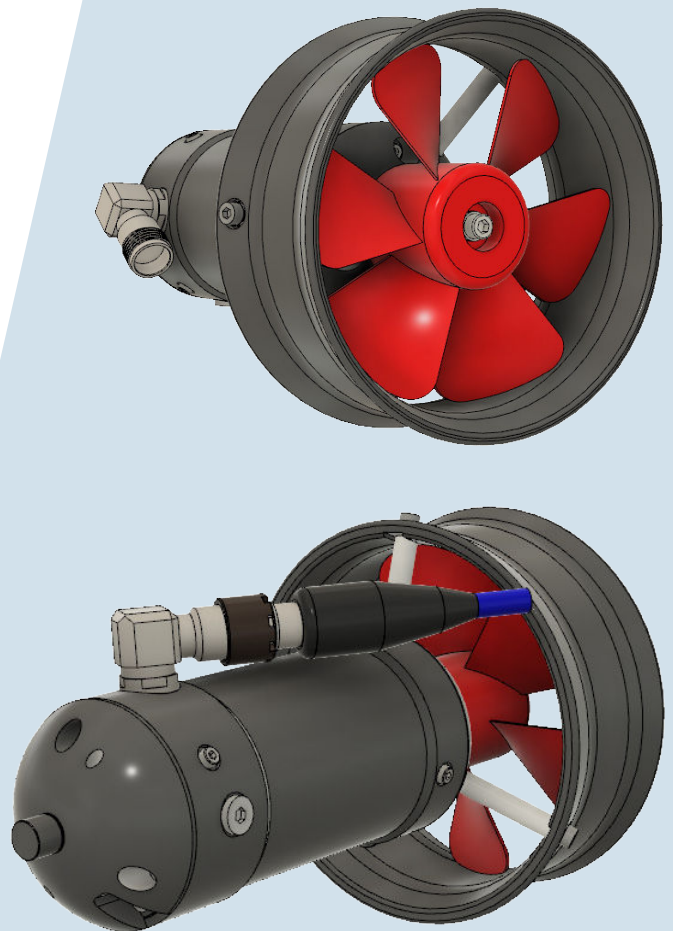

ACTEON

DATA AND
ROBOTICS

Motor Type:	Brushless DC, direct shaft drive
Number of Poles:	12
Nominal Voltage:	320VDC
Maximum Voltage:	340VDC
Nominal Current:	4.5A
Thrust Output:	32kgf (forward) 28.5kgf (reverse) @ 320VDC
RPM:	2200 RPM
Weight in Air:	4.2kg
Weight in Water:	3.4kg
Depth Rating:	1000m standard, 6000m max (optional)
Control Electronics:	24Vdc at 160mA
Control Methods:	Serial (RS485 multi-drop) or Analogue (+/-5V)
Connector:	CRE A-Shell, 8-pin Hybrid as Standard

