

Rocksteady



Quick connect lift tool

The Rocksteady lift tool is a quick connector for heavy offshore lifting operations. A fail-safe and visually verifiable lock guarantees safe lifting while saving hours of sling handling.

Save time

Use a single tool for all lifting operations to avoid repetitive and time consuming rigging operations. Rocksteady uses standard lifting interfaces so you maintain complete control and flexibility.

Easy to operate

Long range handheld remote control, crane cabin integration or direct hydraulic operation; the Rocksteady lift tool will be a seamless addition to your lifting operations.

Tough and reliable

Rocksteady is a field proven design ready for rough handling, wear and tear. The lock function can be easily inspected and maintained offshore; and you have manual override in the event of hydraulic supply issues.

Safe as a shackle

Quality manufacture from forged products with load transferred under machined shoulders. Rocksteady is designed and delivered to offshore lifting regulations, with individual load test and 100% NDT. Rocksteady is impossible to partially lock and features clear visual indication of lock/unlock status to provide a quick reference to all personnel that a lift is safe to proceed.

Specifications

Design & manufacture	DNVGL-ST-0378 - Standard for offshore and platform lifting appliances May 2016 Proof load, volumetric and surface NDT, 3.1 certs, CE marking
Applications	Offshore wind pile lifting tools, transition piece lifting tools Hammers, drilling and piling equipment Crane shock absorbing devices Oil & gas decommissioning lifts Marine riser installation and retrieval
Control options	Direct hydraulic, radio remote control (range up to 300m), acoustic remote control (subsea)
Tested performance	High speed impact (3m/s), offset and 15° angled connection Connect / disconnect endurance (no galling, no wear)
Receptacle options	Padeye (shackle interface), trunnions for slings, bolted flange, self-righting receptacle with free-stroke (hammer/crane isolation), receptacle mounted actuation (connector passive)

Model	RSL500	RSL1000	RSL2000	RSL3000
WLL (tonnes)	500	1000	2000	3000
Weight (kg)	480	1310	3720	6810
Diameter (mm)	360	505	715	875
Length (mm)	870	1220	1730	2110

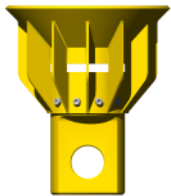

Standard receptacle with shackle interface. Available with stands to sit flat on deck.

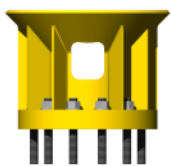

Bolted flange receptacle. Available with extended funnel (as shown) for up-righting of moderate loads.

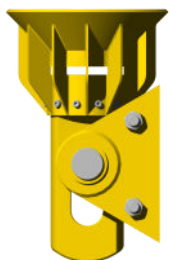

Always-up, telescoping receptacle. Ideal for up-righting heavy loads and isolating crane from pile hammering.



One of four custom Rocksteady hydraulic lift tools delivered for an O&G client.

Rocksteady

ACTEON

www.srpsubsea.com | info@srpsubsea.com | +44 (0) 1483 775 000

Every effort has been made to ensure the data on this sheet is accurate at the time of issue, however, it is subject to revision. SRP is a division of Large Diameter Drilling Ltd, an Acteon Company. Rocksteady is a trademark of Large Diameter Drilling Ltd ©